



GROOVED FITTINGS

GROOVED PIPING SYSTEM GUIDELINES

Grooved piping systems require a careful coupling selection. To ensure a properly set up system use the following guidelines:

- 1) The coupling must suit the pipe O.D., and pressure rating for the application in which it is to be used.
- 2) Use the correct gasket to suit the media being transported/conveyed.
- 3) Make sure the correct groove dimension is used to ensure the correct fittings of the coupling to the pipe.

The following industry standards must be followed to ensure a correct pipe joint assembly.

- a) All bolts should be torqued evenly to achieve metal to metal contact at the bolt pads.
- b) Tongue and recess housings must be checked for correct alignment.
- c) Apply Dixon gasket lubricant to all rubber surfaces to ensure a no pinch assembly.
- d) Test the system slowly (preferably hydrostatically) and check for leaks.
- e) Depressurize the system before carefully dismantling the couplings.

HOSE COUPLING SAFETY

Most of Dixon's products are designed to couple to hose. This brochure primarily focuses on Dixon's pipe fittings.

Dixon's couplings and retention devices are designed to work safely for their intended use. The selection of the proper hose, coupling and retention device, and the proper application of the coupling to the hose are of utmost importance.

Users must consider the size, temperature, application, media, pressure and hose and coupling manufacturer's recommendations when selecting the proper hose assembly components. Dixon recommends that all hose assemblies be tested in accordance with the Rubber Manufacturers Association's recommendations and be inspected regularly (before each use) to ensure that they are not damaged or have become loose.

Where safety devices are integral to the coupling, they must be working and utilized. The use of supplementary safety devices such as safety clips or safety cables are recommended.

If any problem is detected, couplings must be removed from service immediately.

Dixon is available to consult, train and recommend the proper selection and application of all fittings we sell. We strongly recommend that distributors and end users make use of Dixon's Testing and Recommendation Services. Dixon can be contacted at 1-800-355-1991.

FEATURES and BENEFITS

Grooved End fittings for grooved pipe combine the features of a straight line or a flexible coupling, a union and an extension at each pipe joint. The housings engage the groove around the entire pipe circumference, locking the pipe together.

Grooved End fittings allow easy removal of pipe sections for replacement, cleaning and service.

Since the grooves are not as deeply cut as threaded pipe, less metal is removed and more of the pressure rating of the pipe is retained.

Installation time and cost is low, since only a socket wrench is required.

INSTALLATION INSTRUCTIONS



1

A socket wrench is the only tool needed to assemble the gasket, housing, nuts and bolts.

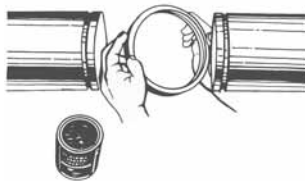

2

Before installing the gasket, make sure that the pipe ends are correctly grooved. Remove any burrs, scores, rust or other imperfections from the pipe ends and gasket.

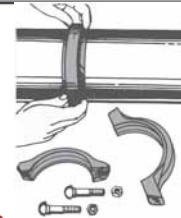

3

Smear ordinary rubber grease on the inside and outside of the gasket. Stretch the gasket over one pipe end and bring the other pipe to be coupled into alignment. Slide the gasket into the center between the grooves on the two pipe ends.



4

Attach the two sections of the housings and insert the bolts and nuts.



5

Tighten the bolts evenly until the housings are firmly together with the metal touching.

STANDARD COUPLINGS

Standard Couplings are designed for a wide range of applications: commercial/industrial construction, mining, process piping, and many others. The housing design allows for optimum strength without excessive casting weight. Ductile Iron body with rust inhibiting paint. **UL Listed and FM Approved.**



Interchangeable with:
Victaulic's #77
Grinnell's #7001

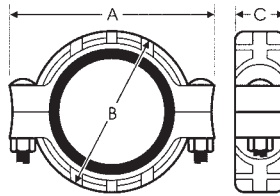

Part # w/EPDM Gasket	Part # w/Buna-N Gasket	Nominal Size	Pipe O.D.	Max. Working Pressure PSI	Max. End Load, Lbs.	Coupling Dimensions			Coupling Bolts		Approx. Weight Each, Lbs.
						A	B	C	Qty.	Size	
<i>C115</i>	<i>C115BU</i>	1 1/2	1.900	1000	2835	4 9/16	3 1/4	1 3/4	2	1/2 x 2 1/2	2.3
<i>C12</i>	<i>C12BU</i>	2	2.375	1000	4430	5 3/8	3 5/8	1 3/4	2	1/2 x 2 1/2	2.7
<i>C125</i>	<i>C125BU</i>	2 1/2	2.875	1000	6492	6 1/4	4 1/4	1 3/4	2	1/2 x 2 1/2	3.7
<i>C13</i>	<i>C13BU</i>	3	3.500	1000	9621	7	5	1 3/4	2	1/2 x 2 3/4	4.1
<i>C14</i>	<i>C14BU</i>	4	4.500	1000	15904	8 1/2	6 3/8	2 1/16	2	5/8 x 3 1/4	6.7
<i>C16</i>	<i>C16BU</i>	6	6.625	1000	34472	11 1/2	8 7/8	2 1/16	2	3/4 x 4 1/4	12.0
<i>C18</i>	<i>C18BU</i>	8	8.625	800	46741	14 1/4	11 1/4	2 3/8	2	7/8 x 5	19.1
<i>C20</i>	<i>C20BU</i>	10	10.750	800	72610	16	13 1/2	2 1/2	2	7/8 x 5 1/2	24.6
<i>C24</i>	<i>C24BU</i>	12	12.750	800	102141	18	15 1/2	2 1/2	2	7/8 x 6	27.5

LIGHTWEIGHT FLEXIBLE COUPLINGS

Lightweight Flexible Couplings are designed for applications requiring moderate internal pressure or where weight is a factor. Applications include: general purpose, mining, irrigation, and compressed air where a deflection of 5% or less is required. Ductile Iron body with rust inhibiting paint. **UL Listed and FM Approved.**



Interchangeable with:
Victaulic's #75
Grinnell's #7000

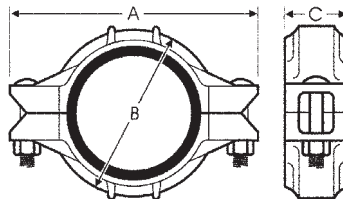

Part # w/EPDM Gasket	Part # w/Buna-N Gasket	Nominal Size	Pipe O. D.	Max. Working Pressure PSI	Max. End Load, Lbs.	Coupling Dimensions			Coupling Bolts		Approx. Weight Each, Lbs.
						A	B	C	Qty.	Size	
<i>L215</i>	<i>L215BU</i>	1 1/2	1.900	500	1418	4 1/2	2 7/8	1 3/4	2	3/8 x 1 7/8	1.5
<i>L02</i>	<i>L02BU</i>	2	2.375	500	2215	5 5/32	3 11/32	1 3/4	2	3/8 x 1 7/8	1.7
<i>L025</i>	<i>L025BU</i>	2 1/2	2.875	300	3246	5 25/32	3 29/32	1 3/4	2	3/8 x 2	2.2
<i>L03</i>	<i>L03BU</i>	3	3.500	300	4811	6 35/64	4 3/8	1 51/64	2	1/2 x 2 1/2	2.8
<i>L04</i>	<i>L04BU</i>	4	4.500	300	6362	8 3/64	5 21/32	1 15/16	2	1/2 x 2 3/4	3.7
<i>L05</i>	<i>L05BU</i>	5	5.563	300	9722	9 1/2	6 3/4	2	2	5/8 x 3 1/4	5.7
<i>L06</i>	<i>L06BU</i>	6	6.625	300	13789	10 53/64	7 7/8	2	2	5/8 x 3 1/4	7.4
<i>L08</i>	<i>L08BU</i>	8	8.625	300	20449	13 7/8	10 13/64	2 13/32	2	3/4 x 4 1/4	12.8

QUICK RELEASE COUPLINGS

Quick Release Couplings are specially designed for applications requiring a quick connection and/or disconnection of a pipe joint. A locking pin through the handle prevents accidental opening of the coupling. Ductile Iron body with Zinc plating and Steel Safety Clip.

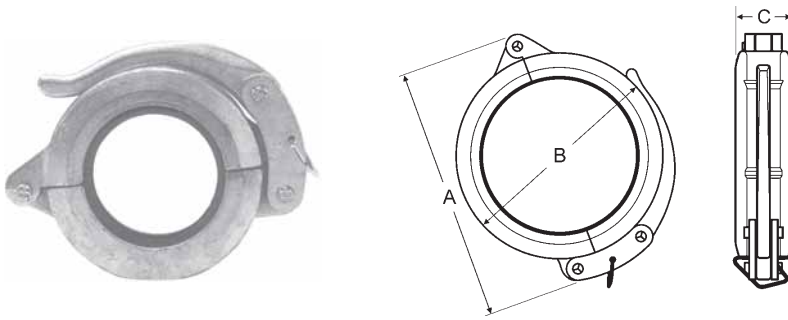

Interchangeable with:
Victaulic's #78
Grinnell's #7003

Part # w/EPDM Gasket	Part # w/Buna-N Gasket	Nominal Size	Pipe O.D.	Max. Working Pressure PSI	Max. End Load, Lbs.	Coupling Dimensions			Approx. Weight Each, Lbs.
						A	B	C	
<i>H315</i>	<i>H315BU</i>	1 1/2	1.900	500	850	4 3/4	3 1/2	1	1.5
<i>H32</i>	<i>H32BU</i>	2	2.375	500	1329	5 1/2	3 3/4	1 3/4	2.5
<i>H325</i>	<i>H325BU</i>	2 1/2	2.875	500	2120	5 7/8	4 3/4	1 7/8	4.0
<i>H33</i>	<i>H33BU</i>	3	3.500	500	2886	7 1/4	5 1/4	1 3/4	3.8
<i>H34</i>	<i>H34BU</i>	4	4.500	500	4771	8 1/2	6 1/2	2	6.0
<i>H36</i>	<i>H36BU</i>	6	6.625	500	10341	10 5/8	8 1/2	2	8.6

RIGID COUPLINGS

This lightweight, low pressure, rigid style coupling is ideal for fire protection, plumbing, low pressure air and drainage. Small gripping teeth hold the housing into the groove allowing a straight run of pipe and preventing any flex at the joint. Ductile Iron body with rust inhibiting paint. **UL Listed and FM Approved.**

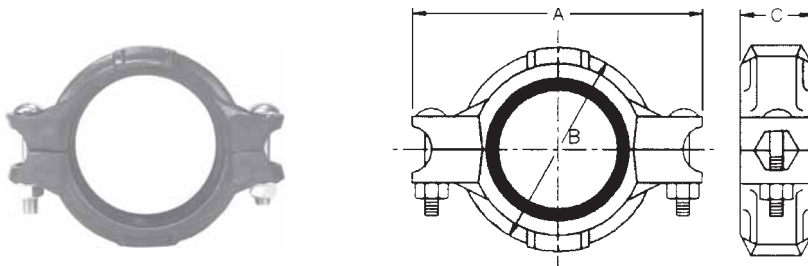

Interchangeable with:
Victaulic's #005
Grinnell's #7400

Part # w/EPDM Gasket	Part # w/Buna-N Gasket	Nominal Size	Pipe O.D.	Max. Working Pressure PSI	Max. End Load, Lbs.	Coupling Dimensions			Coupling Bolts		Approx. Weight Each, Lbs.
						A	B	C	Qty.	Size	
<i>R72</i>	<i>R72BU</i>	2	2.375	175	4425	5	3 15/64	1 3/4	2	3/8 x 2	1.5
<i>R725</i>	<i>R725BU</i>	2 1/2	2.875	175	6490	5 5/8	3 45/64	1 3/4	2	3/8 x 2	1.7
<i>R73</i>	<i>R73BU</i>	3	3.500	175	9620	6 29/64	4 5/16	1 3/4	2	3/8 x 2	2.5
<i>R74</i>	<i>R74BU</i>	4	4.500	175	12720	7 53/64	5 17/32	2	2	1/2 x 2 3/4	3.6
<i>R76</i>	<i>R76BU</i>	6	6.625	175	27570	10 23/64	7 37/64	2	2	5/8 x 3 1/4	5.8
<i>R78</i>	<i>R78BU</i>	8	8.625	175	35050	13 25/32	10	2 21/64	2	5/8 x 3 1/4	15.9

Mechanical Tees provide a fast easy way to install a threaded connection along a length of pipe. After drilling or cutting a hole in the pipe at the location of the branch connection, simply attach the clamps around the pipe for a leak-free threaded outlet connection. See chart below for drilling hole specifications. Ductile Iron body with rust inhibiting paint. **UL listed and FM approved.**



Interchangeable with:
Victaulic's #920
Grinnell's #7045

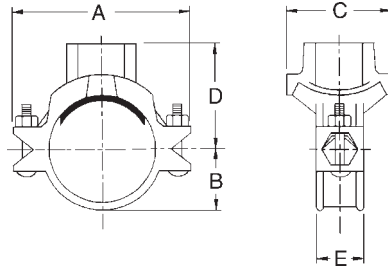

Max. Working Pressure: 300 PSI.

Nominal x Branch Size	Part #	Hole Saw Dia.	Max. Hole Dia.	Clamp Dimensions					Coupling Bolts		Approx. Weight Each, Lbs.
				A	B	C	D	E	Qty.	Size	
2 x 1	MT2010	1 1/2	1 5/8	5 1/16	1 1/2	2 3/4	2 5/8	1 7/8	2	3/8 x 2	2.4
2 x 1 1/4	MT20125	1 3/4	1 7/8	5 1/16	1 1/2	2 15/16	2 3/4	1 7/8	2	3/8 x 2	2.9
2 x 1 1/2	MT20150	1 3/4	1 7/8	5 1/16	1 1/2	2 15/16	2 3/4	1 7/8	2	3/8 x 2	2.8
2 1/2 x 1	MT25010	1 1/2	1 5/8	5 5/32	1 11/16	3	2 31/32	2	2	1/2 x 2 5/8	3.1
2 1/2 x 1 1/4	MT250125	2	2 1/8	5 13/16	1 11/16	3 11/32	3	2	2	1/2 x 2 5/8	3.3
2 1/2 x 1 1/2	MT250150	2	2 1/8	5 13/16	1 11/16	3 11/32	3	2	2	1/2 x 2 5/8	3.1
3 x 1	MT3010	1 1/2	1 5/8	6 11/32	2 1/8	3 3/32	3 1/16	2	2	1/2 x 2 3/4	3.3
3 x 1 1/4	MT30125	2	2 1/8	6 11/32	2 1/8	3 3/4	3 3/8	2	2	1/2 x 2 3/4	4.0
3 x 1 1/2	MT30150	2	2 1/8	6 11/32	2 1/8	3 3/4	3 3/8	2	2	1/2 x 2 3/4	3.4
3 x 2	MT3020	2 1/2	2 5/8	6 11/32	2 1/8	4 1/8	3 3/8	2	2	1/2 x 2 3/4	4.0
4 x 1	MT4010	1 1/2	1 5/8	7 5/16	2 9/16	3 3/32	3 1/2	2	2	1/2 x 2 3/4	4.4
4 x 1 1/4	MT40125	2	2 1/8	7 5/16	2 9/16	3 3/4	3 7/8	2	2	1/2 x 2 3/4	5.1
4 x 1 1/2	MT40150	2	2 1/8	7 5/16	2 9/16	3 3/4	3 7/8	2	2	1/2 x 2 3/4	4.9
4 x 2	MT4020	2 1/2	2 5/8	7 5/16	2 9/16	4 1/8	4	2	2	1/2 x 2 3/4	5.3
4 x 2 1/2	MT40250	2 3/4	2 7/8	7 5/16	2 9/16	4 3/8	4	2	2	1/2 x 2 3/4	5.4
4 x 3	MT4030	3 1/2	3 5/8	7 5/16	2 9/16	5 1/4	4 1/4	2	2	1/2 x 2 3/4	6.4
6 x 1 1/4	MT60125	2 1/2	2 5/8	10 5/32	3 11/16	4 1/8	4 7/8	2 1/4	2	5/8 x 3 1/4	8.6
6 x 1 1/2	MT60150	2 1/2	2 5/8	10 5/32	3 11/16	4 1/8	4 7/8	2 1/4	2	5/8 x 3 1/4	8.4
6 x 2	MT6020	2 1/2	2 5/8	10 5/32	3 11/16	4 1/8	5	2 1/4	2	5/8 x 3 1/4	7.6
6 x 2 1/2	MT60250	2 3/4	2 7/8	10 5/32	3 11/16	4 3/8	5 1/8	2 1/4	2	5/8 x 3 1/4	8.4
6 x 3	MT6030	3 1/2	3 5/8	10 5/32	3 11/16	5 1/4	5 3/8	2 1/4	2	5/8 x 3 1/4	9.2
6 x 4	MT6040	4 1/2	4 5/8	10 5/32	3 11/16	6 1/4	5 3/8	2 1/4	2	5/8 x 3 1/4	9.8

GROOVED END FITTINGS

These Ductile Iron fittings are designed to provide minimum pressure drop and uniform strength. Maximum working pressure for these fittings is **1000 PSI**. Ductile Iron body with rust inhibiting paint. **Interchangeable with Victaulic and Grinnell styles listed below. UL listed and FM approved.**



Interchangeable with:
Victaulic's #110
Grinnell's #7051

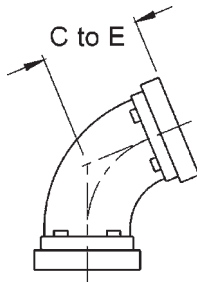

45° Elbows

Nominal Size	Part #	Center to End	Approx. Weight Each, Lbs.
2	L2045	2	1.4
2 1/2	L2545	2 1/4	2.3
3	L3045	2 1/2	3.2
4	L4045	3	5.3
5	L5145	3 1/4	7.9
6	L6045	3 1/2	11.0
8	L8045	4 1/4	20.0



Interchangeable with:
Victaulic's #10
Grinnell's #7050

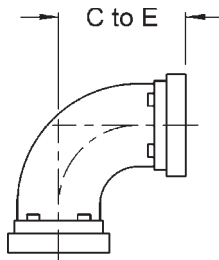

90° Elbows

Nominal Size	Part #	Center to End	Approx. Weight Each, Lbs.
2	L502	3 1/4	2.1
2 1/2	L5025	3 3/4	3.0
3	L503	4 1/4	4.7
4	L504	5	7.3
5	L505	5 1/2	12.0
6	L506	6 1/2	17.6
8	L508	7 3/4	31.9



Interchangeable with:
Victaulic's #20
Grinnell's #7060

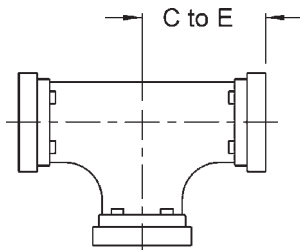

Tees

Nominal Size	Part #	Center to End	Approx. Weight Each, Lbs.
2	T602	3 1/4	3.2
2 1/2	T6025	3 3/4	4.5
3	T603	4 1/4	5.9
4	T604	5	11.0
5	T605	5 1/2	16.3
6	T606	6 1/2	24.6
8	T608	7 3/4	40.0



Galvanized

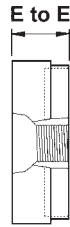

ANSI End Caps with Tapped Outlet

Nominal Size x Outlet	Part #	End to End	Approximate Weight Each, Lbs.
2 x 1	EC201	7/8	.50
2 1/2 x 1	EC251	7/8	.70
3 x 1	EC301	7/8	1.05
4 x 1	EC401	1	2.30
4 x 2	EC402	1	2.10
6 x 1	EC601	1	5.10
6 x 2	EC602	1	5.35
8 x 2	EC802	1 3/16	10.10

Interchangeable with:

Victaulic's #60
Grinnell's #7074



Galvanized

Blank End Caps

Nominal Size	Part #	End to End	Approximate Weight Each, Lbs.
2	BEC20	7/8	.6
2 1/2	BEC25	7/8	.7
3	BEC30	7/8	1.1
4	BEC40	1	2.6
6	BEC60	1	5.0
8	BEC80	1 3/16	11.0

ADAPTER NIPPLES

These fittings are designed to provide minimum pressure drop and uniform strength. Maximum working pressure is 1000 PSI.

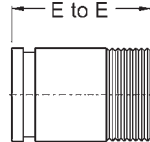

Long Pipe Style

Nominal Size	Part #	End to End
2	A712	4
2 1/2	A7125	4
3	A713	4
4	A714	6
5	A715	6
6	A716	6

Long Pipe Style Nipples will be discontinued as inventory is depleted.

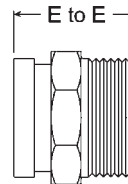

Short Hex Style

Nominal Size	Part #	End to End
2	A712S	2 3/8
2 1/2	A7125S	2 5/8
3	A713S	2 7/8
4	A714S	3 1/2

REDUCING ADAPTERS

Grooved End x Grooved End

Nominal x Nominal Size	Part #	End to End	Approx. Weight Lbs.
2 x 1 1/2	RAGG20150	2.5	0.9
2 1/2 x 2	RAGG25020	2.5	1.1
3 x 2	RAGG3020	2.5	1.2
3 x 2 1/2	RAGG30250	2.5	1.5
4 x 2	RAGG4020	3.0	2.2
4 x 2 1/2	RAGG40250	3.0	2.4
4 x 3	RAGG4030	3.0	2.4
5 x 4	RAGG5040	3.5	4.4
6 x 2	RAGG6020	4.0	4.0
6 x 2 1/2	RAGG60250	4.0	4.4
6 x 3	RAGG6030	4.0	4.6
6 x 4	RAGG6040	4.0	7.0



Interchangeable with:

Victaulic's #50
Grinnell's #7072

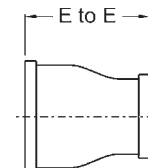

FLANGE ADAPTERS

Flange Adapters are used to connect an ANSI Class 125 & 150 flange to a grooved pipe using a grooved clamp. These adapters provide a rigid one piece connection that can be disconnected by removing the clamp assembly. Ductile Iron construction with rust inhibiting Galvanized Finish.

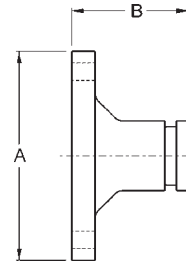

Flange x Grooved End

Part #	Nominal Size	Pipe O.D.	Max. Working Pressure PSI	Flange Dimensions		Coupling Bolts		Approximate Weight Each, Lbs.
				A	B	Qty.	Diameter	
<i>FA20</i>	2	2.375	300	6	2 3/8	4	5/8	2.8
<i>FA30</i>	3	3.500	300	7 1/4	2 3/8	4	5/8	5.3
<i>FA40</i>	4	4.500	300	8 1/2	2 3/8	8	5/8	6.4
<i>FA60</i>	6	6.625	300	11	2 9/16	8	3/4	11.5
<i>FA80</i>	8	8.625	300	13 1/4	3	8	3/4	23.0

ANSI SPLIT FLANGE COUPLINGS

The Split Flange Coupling is designed to provide a direct connection between a grooved adapter and an ANSI Class 125 & 150 raised face flanged component. Can be used with flat face flanges by removing the raised projections on the outside face of the flange. Ductile Iron body with rust inhibiting paint. **UL Listed and FM Approved.**

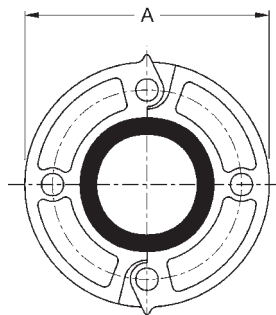

Interchangeable with:
Victaulic's #741
Grinnell's #7012

Part # w/EPDM Gasket	Nominal Size	Pipe O.D.	Max. Working Pressure PSI	Flange Dimensions		Coupling Bolts		Approximate Weight Each, Lbs.
				A	B	Qty.	Diameter	
<i>ANSI20</i>	2	2.375	300	6	13/16	4	5/8	3.5
<i>ANSI25</i>	2 1/2	2.875	300	7	13/16	4	5/8	4.6
<i>ANSI30</i>	3	3.500	300	7 1/2	13/16	4	5/8	5.1
<i>ANSI40</i>	4	4.500	300	9	15/16	8	5/8	8.8
<i>ANSI60</i>	6	6.625	300	11	1	8	3/4	10.6
<i>ANSI80</i>	8	8.625	300	13 1/2	1 1/8	8	3/4	17.0

- Check gasket color code to be certain it is recommended for the service intended.
- Use lubricant on gasket.
- Unless otherwise noted, all gasket listings are based upon **100°F (38°C)** maximum temperature service conditions.
- For services not listed contact Dixon for recommendations.

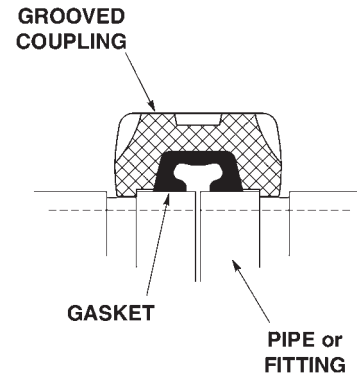

Size	Part #
1 1/2	G150E
2	G200E
2 1/2	G250E
3	G300E
4	G400E
5	G500E
6	G600E
8	G800E

Compound Type: **EPDM.**

Temperature Range: **-22°F to +230°F.**

Color Code: **Black.**

General Service Application:

- Water, dilute acids, alkalis, salts, and many chemical services not involving hydrocarbons, oils, or gases.
- Air (no oil vapors) temp. **-22°F to 230°F (-30°C to 110°C).** Excellent oxidation resistance.

NOT FOR USE WITH HYDROCARBONS.

Size	Part #
1 1/2	G150T
2	G200T
2 1/2	G250T
3	G300T
4	G400T
5	G500T
6	G600T
8	G800T

Compound Type: **Buna-N.**

Temperature Range: **-24°F to +176°F.**

Color Code: **Black with orange stripe.**

General Service Application:

- Petroleum products, vegetable oils, mineral oils, and air contaminated with petroleum oils.
- Air, oil vapor, temp. **-24°F to 176°F (-31°C to 80°C).**

NOT FOR USE IN HOT WATER SERVICES.

Part #	Bolt Description	Torque, Ft. Lbs.
BLT38200	3/8 x 2	30
BLT50200	1/2 x 2	50
BLT50212	1/2 x 2 1/2	50
BLT50234	1/2 x 2 3/4	50
BLT58314	5/8 x 3 1/4	75
BLT75414	3/4 x 4 1/4	75
BLT78600	7/8 x 6	100

- The Nuts are a heavy hexagon design.
- Nuts and Bolts are made of electroplated Carbon Steel and conform to ASTM A183, with a minimum tensile strength of 110,000 PSI.

CAST IRON BUTTERFLY VALVES with GROOVED ENDS

Corrosion resistant disc and shaft. Disc has a high flow coefficient design which minimizes flow resistance and cavitation. Nitrile lining molded to the body. Lever Actuated model's handle can be securely fixed in eleven positions.



Lever Actuated Gearbox Actuated

GROOVED END x GROOVED END

Size	Description	Part #
4"	Lever Actuated	<i>BFVLA400</i>
6"	Lever Actuated	<i>BFVLA600</i>
4"	Gearbox Actuated	<i>BFVGA400</i>
6"	Gearbox Actuated	<i>BFVGA600</i>

- Body and Handle Iron
- Disc and Shaft 316 Stainless Steel
- Nitrile seals
- **290 PSI** Working Pressure

COMPACT HIGH PRESSURE GROOVED END BALL VALVES

Compact, streamlined design suitable for many applications in high pressure pipeline systems, including petroleum, process systems, water, oil and gas. Epoxy coated inside and out for corrosion resistance.



End Size	Part #
4"	<i>HPBV40</i>
6"	<i>HPBV60</i>

- High strength Ductile Iron body
- Stainless Steel ball
- 15% glass reinforced Teflon seats
- Epoxy coated
- **600 PSI** Working Pressure



- Hose nipples, made from tubular stock, to fit straight end hose.
- Combination nipples are recommended for low-pressure discharge and suction service for compatible liquids.
- **Not for compressible products such as air, nitrogen or steam.**
- The working pressure of combination nipples will vary with the size and construction of the hose, the type and number of clamps used, clamp placement, proper installation of clamps, temperature and product being conveyed.
- In accordance with the RMA bulletin for Oil Suction and Discharge Hose, a coupled length of hose, in any size should be tested to 1 1/2 times the working pressure and held for fifteen minutes without leaking or coupling movement.
- Consult Dixon for recommendations specific to the application.

CARBON STEEL

Size	Part #	Pkg Qty
1"	<i>STV10</i>	50
1 1/4"	<i>STV15</i>	50
1 1/2"	<i>STV20</i>	50
2"	<i>STV25</i>	25
2 1/2"	<i>STV30</i>	10
3"	<i>STV35</i>	10
4"	<i>STV40</i>	5
5"	<i>STV50</i>	4
6"	<i>STV60</i>	2
8"	<i>STV80</i>	2
10"	<i>STV100</i>	1
12"	<i>STV120</i>	1

316 STAINLESS STEEL

Size	Part #	Pkg Qty
1 1/2"	<i>RSTV20</i>	50
2"	<i>RSTV25</i>	25
3"	<i>RSTV35</i>	10
4"	<i>RSTV40</i>	5



Size	Part #		Dimensions			
	CARBON STEEL	316 STL. STEEL	A	B	C	D
1"	<i>STV10</i>	-----	3 7/16"	1 5/8"	1 1/32"	1.315
1 1/4"	<i>STV15</i>	-----	3 7/8"	1 7/8"	1 9/32"	1.660
1 1/2"	<i>STV20</i>	<i>RSTV20</i>	4 1/16"	2 1/8"	1 17/32"	1.900
2"	<i>STV25</i>	<i>RSTV25</i>	4 5/8"	2 1/2"	2 1/32"	2.375
2 1/2"	<i>STV30</i>	-----	5 9/16"	2 7/8"	2 17/32"	2.875
3"	<i>STV35</i>	<i>RSTV35</i>	6 1/8"	3 1/4"	3 1/32"	3.500
4"	<i>STV40</i>	<i>RSTV40</i>	7 5/16"	3 7/8"	4 1/32"	4.500
5"	<i>STV50</i>	-----	9 13/16"	5 3/8"	5 1/32"	5.563
6"	<i>STV60</i>	-----	11"	6 1/2"	6 3/64"	6.625
8"	<i>STV80</i>	-----	12 1/2"	7 3/4"	8 3/64"	8.625
10"	<i>STV100</i>	-----	14"	8 1/2"	10 3/64"	10.750
12"	<i>STV120</i>	-----	16"	10 1/8"	12 3/64"	12.750

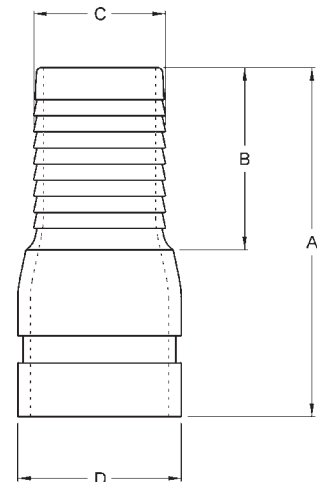

ADVANTAGES of GROOVED FITTINGS



Built in deflection tolerances allow for quicker installation & easier pipe alignment in uneven areas, or, where ground settling may occur

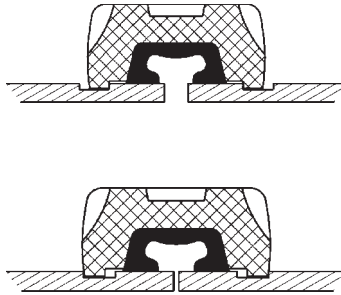

Grooved couplings allow for some linear expansion & contraction as well as horizontal variance. These features eliminate limited pipeline stresses without the use of costly expansion joints.

Comparative Advantages	<i>Threaded</i>	<i>Flanged</i>	<i>Welded</i>	GROOVED
Allows angular deflection-misalignment				✓
Expansion, contraction or, no need for expansion joint				✓
Reclaimable, no need for union		✓		✓
Allows fast connection with valves				✓
Allows rotation of pipe for alignment		✓		✓
No special skills required	✓			✓
No welding slags	✓			✓
No weakening of pipe at joints		✓	✓	✓
No fire hazard during installation	✓	✓		✓
Speed of installation	✓			✓
Allows prefabrication	✓	✓		✓
Low installation cost	✓			✓



Dixon Valve & Coupling Company
800 High Street • Chestertown, Maryland 21620
410-778-2002 • Toll Free Customer Service: 800-355-1991
410-778-4702 • Toll Free Fax: 800-283-4966