

Pneumatic Tubing Fittings

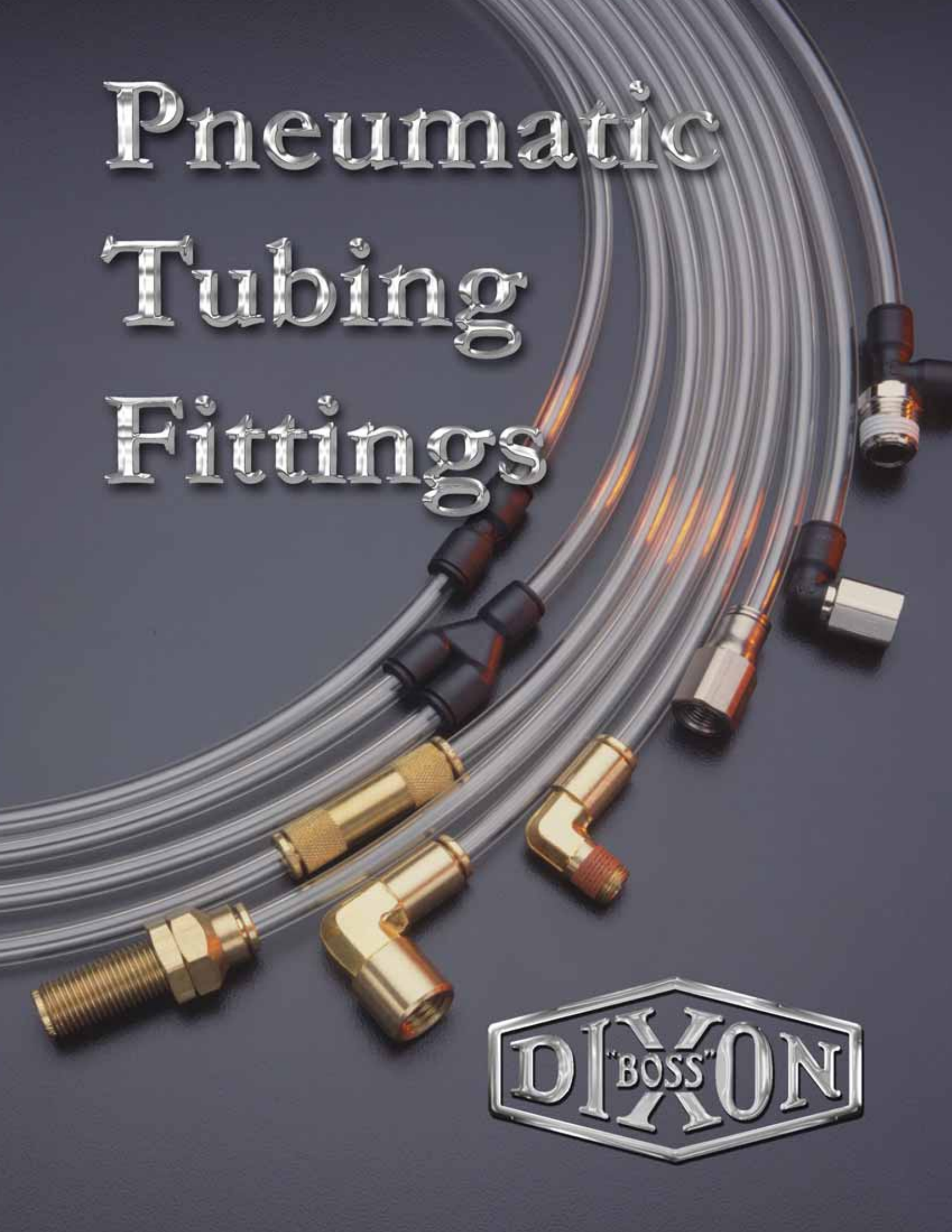

BRASS FITTINGS

DESIGN FEATURES:

- **Quick Connect:** Simply push tubing in. No tools required. Saves up to 75% of assembly time required for standard compression fittings.
- **Quick Disconnect:** Hold two fingers on the insert and pull tubing out. No tools required.
- **Reusable:** Connect and disconnect tubing many times.
- **Full Flow Design:** Provides up to 60% more flow than other conventional fittings with internal tube supports.
- **Positive Seal:** No leaks. Once tubing is inserted, seal is made.
- **Versatile:** Buna-N O-rings are standard. Other O-ring materials are optional.
- **Secure Tube Retention:** Pulling on tubing only tightens the connection.
- **Self Contained Assembly:** No loose parts, brass body and insert.
- **Brass Construction:** Elbows and tees are Forged Brass.
- **Pre-Applied Thread Sealant:** A Teflon based sealant is applied as a labor reducing feature.
- **Working Pressure:** Fittings are suitable for use up to the maximum working pressure of the plastic tubing used. Also suitable for vacuum service.
- **Working Temperature:** -10°F to 200°F

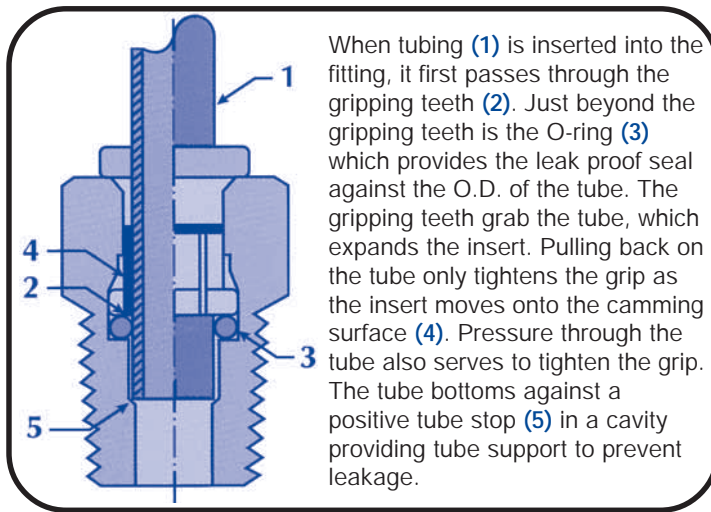

Male Swivel Elbow

(Tube to Male NPT)

Tube O.D.	Male NPT	Part #	Pkg Qty
1/8"	1/8"	69S4x4	10
5/32"	10-32*	69S5x10	10
5/32"	1/8"	69S5x4	10
5/32"	1/4"	69S5x8	10
1/4"	10-32*	69S8x10	10
1/4"	1/8"	69S8x4	10
1/4"	1/4"	69S8x8	10
1/4"	3/8"	69S8x12	10
3/8"	1/8"	69S12x4	10
3/8"	1/4"	69S12x8	10
3/8"	3/8"	69S12x12	5
1/2"	3/8"	69S16x12	5
1/2"	1/2"	69S16x16	5



* UNF - Straight thread; Supplied with gasket

Male Elbow

(Tube to Male NPT)

Tube O.D.	Male NPT	Part #	Pkg Qty
1/8"	1/8"	694x4	10
5/32"	1/8"	695x4	10
3/16"	1/8"	696x4	10
1/4"	1/8"	698x4	10
1/4"	1/4"	698x8	10
1/4"	3/8"	698x12	10
3/8"	1/8"	6912x4	10
3/8"	1/4"	6912x8	10
3/8"	3/8"	6912x12	10
1/2"	1/4"	6916x8	5
1/2"	3/8"	6916x12	5



Female Elbow

(Tube to Female NPT)

Tube O.D.	Female NPT	Part #	Pkg Qty
5/32"	1/8"	705x4	10
1/4"	1/8"	708x4	10
1/4"	1/4"	708x8	5
3/8"	1/4"	7012x8	5



Union Elbow

(Tube to Tube)

Tube O.D.	Part #	Pkg Qty
1/8"	654	10
5/32"	655	10
1/4"	658	10
3/8"	6512	10
1/2"	6516	5



Union

(Tube to Tube)

Tube O.D.	Part #	Pkg Qty
1/8"	624	20
5/32"	625	10
1/4"	628	10
3/8"	6212	10
1/2"	6216	5



Bulkhead Union

(Tube to Tube)

Tube O.D.	Part #	Pkg Qty
1/8"	824	10
5/32"	825	10
3/16"	826	10
1/4"	828	10
3/8"	8212	5
1/2"	8216	5

BRASS FITTINGS



Male Connector
(Tube to Male NPT)



Female Connector
(Tube to Female NPT)

Tube O.D.	Male NPT	Part #	Pkg Qty	Tube O.D.	Male NPT	Part #	Pkg Qty
1/8"	10-32*	684x10	20	1/4"	1/4"	688x8	10
1/8"	1/8"	684x4	20	1/4"	3/8"	688x12	10
5/32"	10-32*	685x10	20	3/8"	1/8"	6812x4	10
5/32"	1/8"	685x4	20	3/8"	1/4"	6812x8	10
5/32"	1/4"	685x8	10	3/8"	3/8"	6812x12	10
3/16"	10-32*	686x10	20	3/8"	1/2"	6812x16	5
3/16"	1/8"	686x4	20	1/2"	1/4"	6816x8	5
1/4"	10-32*	688x10	20	1/2"	3/8"	6816x12	5
1/4"	1/8"	688x4	20	1/2"	1/2"	6816x16	5

Tube O.D.	Female NPT	Part #	Pkg Qty
1/8"	1/8"	664x4	10
5/32"	1/8"	665x4	10
1/4"	1/8"	668x4	10
1/4"	1/4"	668x8	10
3/8"	1/4"	6612x8	10
3/8"	3/8"	6612x12	5

*UNF - Straight thread; Supplied with gasket



Male Swivel Run Tee
(Tube to Male NPT)



Male Swivel Branch Tee
(Tube to Male NPT)

Tube O.D.	Male NPT	Part #	Pkg Qty
1/8"	1/8"	71S4x4	10
5/32"	10-32*	71S5x10	10
5/32"	1/8"	71S5x4	10
1/4"	1/8"	71S8x4	10
1/4"	1/4"	71S8x8	5
3/8"	1/4"	71S12x8	5
3/8"	3/8"	71S12x12	5
1/2"	3/8"	71S16x12	5
1/2"	1/2"	71S16x16	5

Tube O.D.	Male NPT	Part #	Pkg Qty
1/8"	1/8"	72S4x4	10
5/32"	10-32*	72S5x10	10
5/32"	1/8"	72S5x4	10
1/4"	1/8"	72S8x4	10
1/4"	1/4"	72S8x8	5
3/8"	1/4"	72S12x8	5
3/8"	3/8"	72S12x12	5
1/2"	3/8"	72S16x12	5
1/2"	1/2"	72S16x16	5

* UNF - Straight thread; Supplied with gasket

* UNF - Straight thread; Supplied with gasket



Union Tee
(Tube to Tube)



Male Run Tee
(Tube to Male NPT)



Male Branch Tee
(Tube to Male NPT)

Tube O.D.	Part #	Pkg Qty
1/8"	644	10
5/32"	645	10
3/16"	646	10
1/4"	648	10
3/8"	6412	5
1/2"	6416	5

Tube O.D.	Male NPT	Part #	Pkg Qty
1/8"	1/8"	714x4	10
5/32"	1/8"	715x4	10
3/16"	1/8"	716x4	10
1/4"	1/8"	718x4	10
1/4"	1/4"	718x8	5
3/8"	1/8"	7112x4	5
3/8"	1/4"	7112x8	5
3/8"	3/8"	7112x12	5
1/2"	3/8"	7116x12	5

Tube O.D.	Male NPT	Part #	Pkg Qty
1/8"	1/8"	724x4	10
5/32"	1/8"	725x4	10
3/16"	1/8"	726x4	10
1/4"	1/8"	728x4	10
1/4"	1/4"	728x8	5
3/8"	1/8"	7212x4	5
3/8"	1/4"	7212x8	5
3/8"	3/8"	7212x12	5
1/2"	3/8"	7216x12	5

GENERAL INFORMATION on LEGRIS PUSH-IN FITTINGS

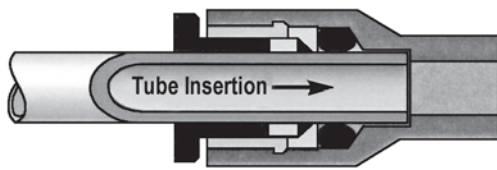

Connection:

1. Make sure the tubing end is cut square.
2. Push the tubing into the fitting until it stops. Tubing is now held and sealed.
3. Pull on the tubing to verify.

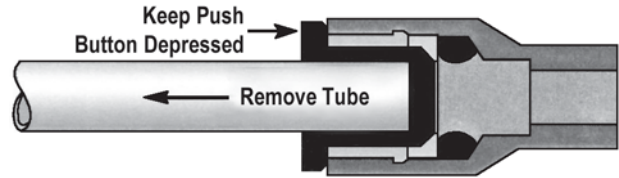

Disconnection:

1. Make sure there is no air flow.
2. Press the release ring towards the fitting and pull the tubing out. No tools required.

General Instructions:

- Make sure the tubing end is cut square and free of burrs or contamination.
- Avoid kinking the tubing, or side stress against the collet, which may cause leaking.
- Tighten threaded fittings by hand, using a wrench on the hex to finish tightening.



NOTE: These fittings are designed for use with Compressed Air ONLY.



LEGRIS NICKEL-PLATED BRASS PUSH-IN FITTINGS

Technical Characteristics:

- Service temperature: -4° F to +250° F
- Pressure: vacuum to + 290 PSI
- Thread: length of threads in accordance with ISO 7.1 standards
- Thread sealant on all NPT threads

Materials of Construction:

- High Phosphorous Electroless: Nickel-plated Brass
- O-ring Seal: Buna Nitrile
- Button: Polypropylene
- Sealing Washers: Nylon
- NO Silicone

Applications:

- Various fluids: compressed air, fluids, compatible with materials of construction.
- Typical industries: automotive, packaging, paper mills, wood working, factories with washdown processes.
- Tube Compatibility: Urethane, Nylon, Polyethylene, Teflon, metallic tubes (Stainless Steel & Copper).

LEGRIS NICKEL-PLATED BRASS FITTINGS



Male Connector
(Tube to Male NPT)

Tube O.D.	Male NPT	Part #	Pkg Qty
5/32"	10-32*	3201 04 20	10
5/32"	1/8"	3275 04 11	10
5/32"	1/4"	3275 04 14	10
1/4"	10-32*	3201 56 20	10
1/4"	1/8"	3275 56 11	10
1/4"	1/4"	3275 56 14	10
1/4"	3/8"	3275 56 18	10
3/8"	1/8"	3275 60 11	10
3/8"	1/4"	3275 60 14	10
3/8"	3/8"	3275 60 18	10
3/8"	1/2"	3275 60 22	10
1/2"	3/8"	3275 62 18	10
1/2"	1/2"	3275 62 22	10

* UNF - Straight thread; Supplied with gasket



Female Connector
(Tube to Female NPT)

Tube O.D.	Female NPT	Part #	Pkg Qty
5/32"	1/8"	3215 04 11	10
5/32"	1/4"	3215 04 14	10
1/4"	1/8"	3215 56 11	10
1/4"	1/4"	3215 56 14	10
3/8"	1/4"	3215 60 14	10
3/8"	3/8"	3215 60 18	10
1/2"	3/8"	3215 62 18	10
1/2"	1/2"	3215 62 22	10



Male Run Swivel Tee
(Tube to Male NPT)

Tube O.D.	Male NPT	Part #	Pkg Qty
5/32"	10-32*	3293 04 20	10
5/32"	1/8"	3203 04 11	10
5/32"	1/4"	3203 04 14	10
1/4"	1/8"	3203 56 11	10
1/4"	1/4"	3203 56 14	10
1/4"	3/8"	3203 56 18	10
3/8"	1/4"	3203 60 14	10
3/8"	3/8"	3203 60 18	10
3/8"	1/2"	3203 60 22	10
1/2"	1/2"	3203 62 22	10

* UNF - Straight thread; Supplied with gasket



Male Elbow Swivel
(Tube to Male NPT)

Tube O.D.	Male NPT	Part #	Pkg Qty
5/32"	10-32*	3299 04 20	10
5/32"	1/8"	3209 04 11	10
5/32"	1/4"	3209 04 14	10
1/4"	1/8"	3209 56 11	10
1/4"	1/4"	3209 56 14	10
1/4"	3/8"	3209 56 18	10
3/8"	1/4"	3209 60 14	10
3/8"	3/8"	3209 60 18	10
3/8"	1/2"	3209 60 22	10
1/2"	1/2"	3209 62 22	10

* UNF - Straight thread; Supplied with gasket



Equal Union
(Tube to Tube)

Tube O.D.	Part #	Pkg Qty
5/32"	3206 04 00	10
1/4"	3206 56 00	10
3/8"	3206 60 00	10
1/2"	3206 62 00	10



Union Elbow
(Tube to Tube)

Tube O.D.	Part #	Pkg Qty
5/32"	3202 04 00	10
1/4"	3202 56 00	10
3/8"	3202 60 00	10
1/2"	3202 62 00	10



Union Tee
(Tube to Tube)

Tube O.D.	Part #	Pkg Qty
5/32"	3204 04 00	10
1/4"	3204 56 00	10
3/8"	3204 60 00	10
1/2"	3204 62 00	10

LEGRIS NYLON/NICKEL-PLATED BRASS FITTINGS

Gripping Ring Technology



Quick Connect and Disconnect: Simply push tubing in. To remove, press the release ring towards the fitting and pull tubing out. No tools required.

Materials: Nickel-plated Brass construction. Black body is glass-filled Nylon; Buna-N O-Ring seal; Polypropylene release button. Silicone free.

Positive Seal: Sealing and holding is accomplished instantaneously.

Reusable: Connect and disconnect numerous times.

Full Flow: Fitting seals on outside diameter of tubing.

Working Pressure: Fittings rated to **275 PSI** at ambient temperature.

Maximum Working Temperature: **175°F**

Pre-applied thread sealant on all male pipe threads.

Compatible Tubing: Semi-rigid Nylon, Polyurethane and Polyethylene tube.



Male Branch Tee
(Tube to Male NPT)

Tube O.D.	Male NPT	Part #	Pkg Qty
1/8"	10-32*	31085320	10
1/8"	1/16"	31085308	10
1/8"	1/8"	31085311	10
5/32"	10-32*	31080420	10
5/32"	1/8"	31080411	10
5/32"	1/4"	31080414	10
1/4"	1/8"	31085611	10
1/4"	1/4"	31085614	10
1/4"	3/8"	31085618	10
5/16"	1/8"	31080811	10
5/16"	1/4"	31080814	10
5/16"	3/8"	31080818	10
3/8"	1/8"	31086011	10
3/8"	1/4"	31086014	10
3/8"	3/8"	31086018	10
3/8"	1/2"	31086022	10
1/2"	1/4"	31086214	10
1/2"	3/8"	31086218	10
1/2"	1/2"	31086222	10

* UNF - Straight thread; Supplied with gasket



Male Run Tee
(Tube to Male NPT)

Tube O.D.	Male NPT	Part #	Pkg Qty
1/8"	10-32*	31035320	10
1/8"	1/16"	31035308	10
1/8"	1/8"	31035311	10
5/32"	10-32*	31030420	10
5/32"	1/8"	31030411	10
5/32"	1/4"	31030414	10
1/4"	1/8"	31035611	10
1/4"	1/4"	31035614	10
1/4"	3/8"	31035618	10
5/16"	1/8"	31030811	10
5/16"	1/4"	31030814	10
5/16"	3/8"	31030818	10
3/8"	1/8"	31036011	10
3/8"	1/4"	31036014	10
3/8"	3/8"	31036018	10
3/8"	1/2"	31036022	10
1/2"	1/4"	31036214	10
1/2"	3/8"	31036218	10
1/2"	1/2"	31036222	10

* UNF - Straight thread; Supplied with gasket

LEGRIS NYLON/NICKEL-PLATED BRASS FITTINGS



Male Elbow
(Tube to Male NPT)

Tube O.D.	Male NPT	Part #	Pkg Qty
1/8"	10-32*	31095320	10
1/8"	1/16"	31095308	10
1/8"	1/8"	31095311	10
1/8"	1/4"	31095314	10
5/32"	10-32*	31090420	10
5/32"	1/8"	31090411	10
5/32"	1/4"	31090414	10
1/4"	10-32*	31095620	10
1/4"	1/8"	31095611	10
1/4"	1/4"	31095614	10
1/4"	3/8"	31095618	10
5/16"	1/8"	31090811	10
5/16"	1/4"	31090814	10
5/16"	3/8"	31090818	10
3/8"	1/8"	31096011	10
3/8"	1/4"	31096014	10
3/8"	3/8"	31096018	10
3/8"	1/2"	31096022	10
1/2"	1/4"	31096214	10
1/2"	3/8"	31096218	10
1/2"	1/2"	31096222	10

* UNF - Straight thread; Supplied with gasket



Female Elbow
(Tube to Female NPT)

Tube O.D.	Female NPT	Part #	Pkg Qty
1/8"	1/8"	30095311	10
5/32"	1/8"	30090411	10
5/32"	1/4"	30090414	10
1/4"	1/8"	30095611	10
1/4"	1/4"	30095614	10
5/16"	1/8"	30090811	10
5/16"	1/4"	30090814	10
3/8"	1/4"	30096014	10
1/2"	3/8"	30096218	10



Male Connector
(Tube to Male NPT)

Tube O.D.	Male NPT	Part #	Pkg Qty
1/8"	1/16"	31755308	10
1/8"	1/8"	31755311	10
1/8"	1/4"	31755314	10
5/32"	1/8"	31750411	10
5/32"	1/4"	31750414	10
1/4"	1/8"	31755611	10
1/4"	1/4"	31755614	10
1/4"	3/8"	31755618	10
5/16"	1/8"	31750811	10
5/16"	1/4"	31750814	10
5/16"	3/8"	31750818	10
3/8"	1/8"	31756011	10
3/8"	1/4"	31756014	10
3/8"	3/8"	31756018	10
3/8"	1/2"	31756022	10
1/2"	1/4"	31756214	10
1/2"	3/8"	31756218	10
1/2"	1/2"	31756222	10



Female Connector
(Tube to Female NPT)

Tube O.D.	Female NPT	Part #	Pkg Qty
1/8"	1/8"	30145311	10
1/8"	1/4"	30145314	10
5/32"	1/8"	30140411	10
5/32"	1/4"	30140414	10
1/4"	1/8"	30145611	10
1/4"	1/4"	30145614	10
5/16"	1/8"	30140811	10
5/16"	1/4"	30140814	10
3/8"	1/8"	30146011	10
3/8"	1/4"	30146014	10
3/8"	3/8"	30146018	10

LEGRIS NYLON/NICKEL-PLATED BRASS FITTINGS



Union
(Tube to Tube)

Tube O.D.	Part #	Pkg Qty
1/8"	31065300	10
5/32"	31060400	10
1/4"	31065600	10
5/16"	31060800	10
3/8"	31066000	10
1/2"	31066200	10



Bulkhead Union
(Tube to Tube)

Tube O.D.	Part #	Pkg Qty
1/8"	31165300	10
5/32"	31160400	10
1/4"	31165600	10
5/16"	31160800	10
3/8"	31166000	10
1/2"	31166200	10



Union Elbow
(Tube to Tube)

Tube O.D.	Part #	Pkg Qty
1/8"	31025300	10
5/32"	31020400	10
1/4"	31025600	10
5/16"	31020800	10
3/8"	31026000	10
1/2"	31026200	10



Union Tee
(Tube to Tube)

Tube O.D.	Part #	Pkg Qty
1/8"	31045300	10
5/32"	31040400	10
1/4"	31045600	10
5/16"	31040800	10
3/8"	31046000	10
1/2"	31046200	10



"Y" Male Connector
(Tube to Male NPT)

Tube O.D.	Male NPT	Part #	Pkg Qty
5/32"	1/8"	31480411	10
5/32"	1/4"	31480414	10
1/4"	1/8"	31485611	10
1/4"	1/4"	31485614	10



"Y" Connector
(Tube to Tube)

Tube O.D.	Part #	Pkg Qty
1/8"	31405300	10
5/32"	31400400	10
1/4"	31405600	10
5/16"	31400800	10
3/8"	31406000	10



Plug
(Tube)

Tube O.D.	Part #	Pkg Qty
1/8"	31265300	10
5/32"	31260400	10
1/4"	31265600	10
5/16"	31260800	10
3/8"	31266000	10
1/2"	31266200	10

PUSH-IN FITTING KIT

Kit includes plastic case with threaded connectors, threaded elbows and several tube to tube connectors configurations found above and on page 2. A tubing cutter is also included.

Kit contains the following parts:



TFK

Part #	Qty	Description	Part #	Qty	Description
31755311	10	Tube to Male NPT Connector	31096018	5	Tube to Male NPTElbow
31750411	10	Tube to Male NPT Connector	31060400	10	Tube to Tube Union
31755611	10	Tube to Male NPT Connector	31065600	10	Tube to Tube Union
31755614	10	Tube to Male NPT Connector	31066000	5	Tube to Tube Union
31756014	5	Tube to Male NPT Connector	31400400	10	Y Connector
31756018	5	Tube to Male NPT Connector	31405600	10	Y Connector
31090411	10	Tube to Male NPT Elbow	31406000	5	Y Connector
31095611	10	Tube to Male NPT Elbow	31040400	10	Tube to Tube Union Tee
31095614	10	Tube to Male NPT Elbow	31045600	5	Tube to Tube Union Tee
31096011	5	Tube to Male NPT Elbow	31046000	5	Tube to Tube Union Tee
31096014	5	Tube to Male NPT Elbow	30007100	1	Tubing Cutter

FLOW CONTROL VALVES

Push-to connect, uni-directional flow control valves, with one-piece design, for controlling the speed of a cylinder by regulating air exhaust. Intake air flows freely through the flow control and exhaust air is metered out through a specially designed fine adjustment screw. Control Pressure Range: **15 to 135 PSI**. Temperature Range: **30°F to 160°F**.



**Compact
Flow Control Valve**

Tube O.D.	NPT Size	Part #	Pkg Qty
5/32"	1/8"	70650411	10
1/4"	1/8"	70655611	10
1/4"	1/4"	70655614	10
3/8"	1/4"	70656014	10
3/8"	3/8"	70656018	10



**Miniature Exhaust
Flow Control Valve**

Tube O.D.	NPT Size	Part #	Pkg Qty
5/32"	10-32*	76600420	10
5/32"	1/8"	76600411	10
1/4"	10-32*	76605620	10
1/4"	1/8"	76605611	10
1/4"	1/4"	76605614	10

* UNF - Straight thread; Supplied with gasket

Push-to connect flow control valve for use where cylinder access is difficult or another fitting is attached to the cylinder port. Stackable using 2 joining clips supplied, or panel mountable using existing holes. Working Pressure Range: **15 to 145 PSI**.

**In-Line
Flow Control Valve**

Tube O.D.	Part #	Pkg Qty
5/32"	77700400	10
1/4"	77705600	10
3/8"	77706000	10
1/2"	77706200	10



Allows air to pass in one direction while blocking flow in the other direction. A pressure of more than 7.3 PSI will overcome the spring pressure and allow flow. An arrow indicates free flow direction. Maximum Working Pressure: **145 PSI**.

**Non-Return
In-Line Valve**

Tube O.D.	Part #	Pkg Qty
5/32"	79960400	10
6mm	79960600	10
1/4"	79965600	10
5/16"	79960800	10



TUBING

Polyurethane

- Excellent memory, flexibility and resistance to kinking.
- Resistant to most oils and fuels.
- Low gas and vapor permeability
- High compressive strength
- Low compressive set
- Low extractability levels
- Outstanding abrasion resistance
- Naturally transparent
- Temperature range **-40°F to 165°F** (working pressure decreases significantly above 75°F)



Size		Wall Thickness	Length	Part #	Working Pressure
O.D.	I.D.				
1/8"	x .062"	.0295	250'	04063	233
5/32"	x .094"	.0315	100'	05094	176
1/4"	x .160"	.0450	100'	08160	148
3/8"	x .250"	.0650	100'	12250	147
1/2"	x .320"	.0900	50'	16320	140

Polyethylene

- Designed for FDA applications
- Flexible, lightweight, low-density polyethylene (LDPE) tubing
- Formulated to resist stress cracking
- Temperature range **-50°F to 150°F** (higher temperatures lower working pressures)
- For use with plastic or metal inserts with outer sleeve, ferrule or clamps.



100' Rolls

Size		Wall Thickness	Length	Part #	Working Pressure
O.D.	I.D.				
1/4"	x .125"	.062	100'	0804	180
1/4"	x .170"	.040	100'	0817	120
3/8"	x .250"	.063	100'	1208	120
1/2"	x .375"	.063	100'	1612	90

500' Rolls

Size		Wall Thickness	Length	Tubing Color	Part #	Working Pressure
O.D.	I.D.					
1/4"	x .170"	.040	500'	Black	0817BR	120
1/4"	x .170"	.040	500'	Natural	0817CR	135
3/8"	x .250"	.063	500'	Black	1208BR	120
3/8"	x .250"	.063	500'	Natural	1208CR	120

Nylon 11 Tubing

- Recommended for applications requiring low density, lightweight toughness, flexibility and chemical resistance.
- Temperature range **-60°F to 200°F**
- Naturally transparent
- 100' lengths are packaged in plastic bags.



Size		Wall Thickness	Length	Part #	Working Pressure
O.D.	I.D.				
1/8"	x .093"	.016	100'	04093	225
5/32"	x .106"	.025	100'	05106	275
3/16"	x .138"	.025	100'	06138	225
1/4"	x .170"	.040	100'	08170	265
1/4"	x .180"	.035	100'	08180	250
3/8"	x .275"	.050	100'	12275	220
1/2"	x .375"	.062	100'	16375	200

METRIC PUSH-IN FITTINGS & TUBING

Materials: Nickel-plated Brass construction. Black body is glass-filled Nylon; Buna-N O-Ring seal; Polypropylene release button. Silicone free.

Positive Seal: Sealing and holding is accomplished instantaneously.

Reusable: Connect and disconnect numerous times.

Full Flow: Fitting seals on outside diameter of tubing.

Working Pressure: Fittings rated to **275 PSI** at ambient temperature.

Maximum Working Temperature: 175°F

Pre-applied thread sealant on all male pipe threads.

Compatible Tubing: Semi-rigid Nylon, Polyurethane and Polyethylene tube.

Gripping Ring Technology



Quick Connect and Disconnect:

Simply push tubing in. To remove, press the release ring towards the fitting and pull tubing out. No tools required.

Male Connector

(Tube to Male BSPT)

Tube O.D.	Male BSPT	Part #	Pkg Qty
4mm	1/8"	31750410	10
4mm	1/4"	31750413	10
6mm	1/8"	31750610	10
6mm	1/4"	31750613	10
8mm	1/8"	31750810	10
8mm	1/4"	31750813	10



Female Connector

(Tube to Female BSPP)

Tube O.D.	Female BSPP	Part #	Pkg Qty
4mm	1/8"	31140410	10
4mm	1/4"	31140413	10
6mm	1/8"	31140610	10
6mm	1/4"	31140613	10
8mm	1/8"	31140810	10
8mm	1/4"	31140813	10



Male Elbow

(Tube to Male BSPT)

Tube O.D.	Male BSPT	Part #	Pkg Qty
4mm	1/8"	31090410	10
4mm	1/4"	31090413	10
6mm	1/8"	31090610	10
6mm	1/4"	31090613	10
8mm	1/8"	31090810	10
8mm	1/4"	31090813	10



Male Branch Tee

(Tube to Male BSPT)

Tube O.D.	Male BSPT	Part #	Pkg Qty
4mm	1/8"	31080410	10
4mm	1/4"	31080413	10
6mm	1/8"	31080610	10
6mm	1/4"	31080613	10
8mm	1/8"	31080810	10
8mm	1/4"	31080813	10



METRIC NYLON TUBING ROLLS

Size O.D.	I.D.	Wall Thickness	Length	Part #	Working Pressure
4mm x 2.7mm		.65 mm	25m	1025P0400	275
6mm x 4mm		1 mm	25m	1025P0600	280
8mm x 6mm		1 mm	25m	1025P0800	210



- Resistant to fungus, abrasion, moisture and UV radiation.
- Temperature range **-60°F to 200°F** at 75°F (higher temperatures lower working pressures)
- Translucent color

D.O.T. PUSH-IN FITTINGS & TUBING

Materials:

- Body(straights) tube supports and grippers: Brass CA360.
- Forged Elbows and Tees: Brass CA377.
- "O" Ring: Buna N.
- Thread Sealant: Loctite 516.

Working Pressure: Vacuum to 150 PSI.

Working Temperature: -40°F to +200°F.

Threads: NPTF standard.

Compatible Tubing: Designed for use with SAE J844 Nylon Tubing. Meets Department Of Transportation FMVSS-106.

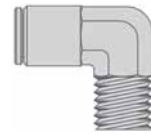

Male Elbow

(Tube to Male NPT)

Tube O.D.	Male NPT	Part #	Pkg Qty
1/4"	1/8"	AQ69DOT4x2	10
1/4"	1/4"	AQ69DOT4x4	10
3/8"	1/4"	AQ69DOT6x4	10

Swivel Male Elbow

(Tube to Male NPT)



Tube O.D.	Male NPT	Part #	Pkg Qty
1/4"	1/8"	AQ69DOTS4x2	10
1/4"	1/4"	AQ69DOTS4x4	10
1/4"	3/8"	AQ69DOTS4x6	10
3/8"	1/4"	AQ69DOTS6x4	10
3/8"	3/8"	AQ69DOTS6x6	5

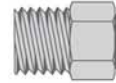

Male Connector

(Tube to Male NPT)

Tube O.D.	Male NPT	Part #	Pkg Qty
1/4"	1/8"	AQ68DOT4x2	10
1/4"	1/4"	AQ68DOT4x4	10
1/4"	3/8"	AQ68DOT4x6	5
3/8"	1/4"	AQ68DOT6x4	10
3/8"	3/8"	AQ68DOT6x6	10

Swivel Male Run Tee

(Tube to Male NPT)

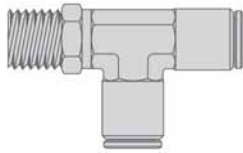

Tube O.D.	Male NPT	Part #	Pkg Qty
1/4"	1/8"	AQ71DOTS4x2	10
1/4"	1/4"	AQ71DOTS4x4	5



Swivel Male Branch Tee

(Tube to Male NPT)

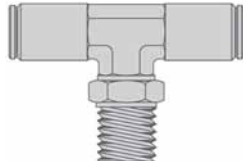

Tube O.D.	Male NPT	Part #	Pkg Qty
1/4"	1/8"	AQ72DOTS4x2	10
1/4"	1/4"	AQ72DOTS4x4	5

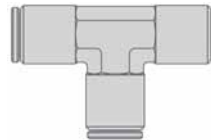

Union Connector

(Tube to Tube)

Tube O.D.	Part #	Pkg Qty
1/4"	AQ62DOT4	10
3/8"	AQ62DOT6	10

Union Tee

(Tube to Tube)

Tube O.D.	Part #	Pkg Qty
1/4"	AQ64DOT4	10
3/8"	AQ64DOT6	10

D.O.T. AIR BRAKE TUBING



Size O.D.	Length	Tubing Color	Part #	Working Pressure
1/4"	100'	Black	J844-04-BL-100	150
1/4"	100'	Blue	J844-04-B-100	150
1/4"	100'	Red	J844-04-R-100	150
3/8"	100'	Black	J844-06-BL-100	150
3/8"	100'	Blue	J844-06-B-100	150
3/8"	100'	Red	J844-06-R-100	150

Meets Department Of Transportation FMVSS-106.
Nylon Material conforming to SAE J844.

HOSE COUPLING SAFETY

Dixon's couplings and retention devices are designed to work safely for their intended use. The selection of the proper hose, coupling and retention device, and the proper application of the coupling to the hose are of utmost importance.

Users must consider the size, temperature, application, media, pressure and hose and coupling manufacturer's recommendations when selecting the proper hose assembly components. Dixon recommends that all hose assemblies be tested in accordance with the Rubber Manufacturers Association's recommendations and be inspected regularly (before each use) to ensure that they are not damaged or have become loose.

Where safety devices are integral to the coupling, they must be working and utilized. The use of supplementary safety devices such as safety clips or safety cables are recommended.

If any problem is detected, couplings must be removed from service immediately.

Dixon is available to consult, train and recommend the proper selection and application of all fittings we sell. We strongly recommend that distributors and end users make use of Dixon's Testing and Recommendation Services. Dixon can be contacted at 1-800-355-1991.