



855, 855A and 860

Hose Crimper Operating Instructions



860 Crimper



855 Crimper

Before operating the 855, 855A or 860 Hose Crimper, close the machine and adjust the screw opposite the end where the handle attaches until the screw just touches the end stop. Never turn the screw tighter than this. The screw should be looser if the hose barb fits very tightly and the ferrule is close - fitting.

- 1** Place ferrule on the hose.
- 2** Dip hose into soapy water before inserting fitting to make the fitting slide in more easily.
- 3** Insert hose barb.
- 4** Open hose crimper by raising handle.
- 5** Place hose into hose crimper, centering the ferrule on the proper die.
- 6** Press down on handle until it hits the end stop. Lift up and rotate hose 90°. Repeat.

NOTE: A properly placed ferrule will fit snugly before crimping and will be difficult to rotate by hand.



855 Crimper Parts Diagram

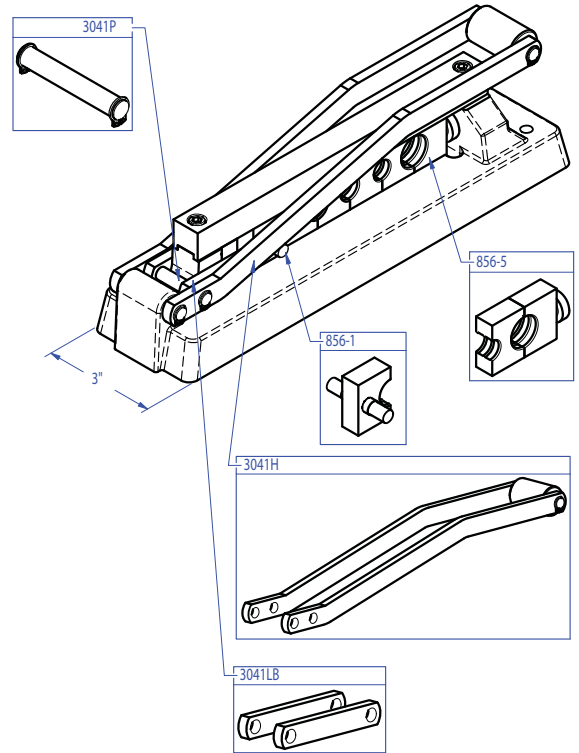
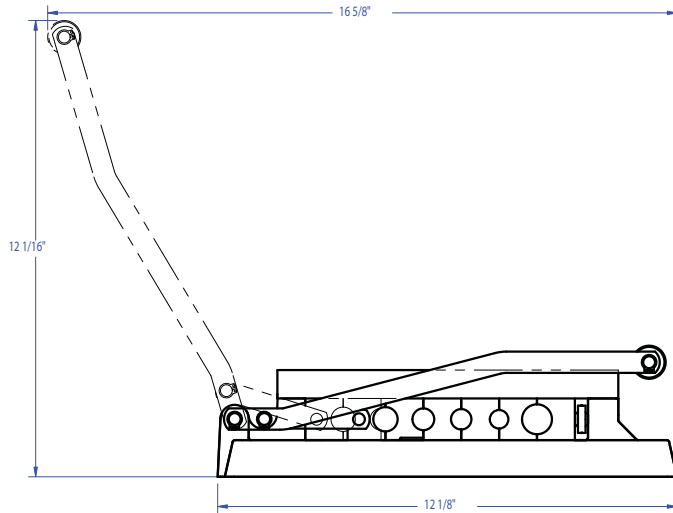

Part #	Description
3041P	die pin
856-5	die's for 855 crimper only
856-1	die's for 855 and 855A
3041H	handle
3041LB	lever bracket

860 Crimper Parts Diagram

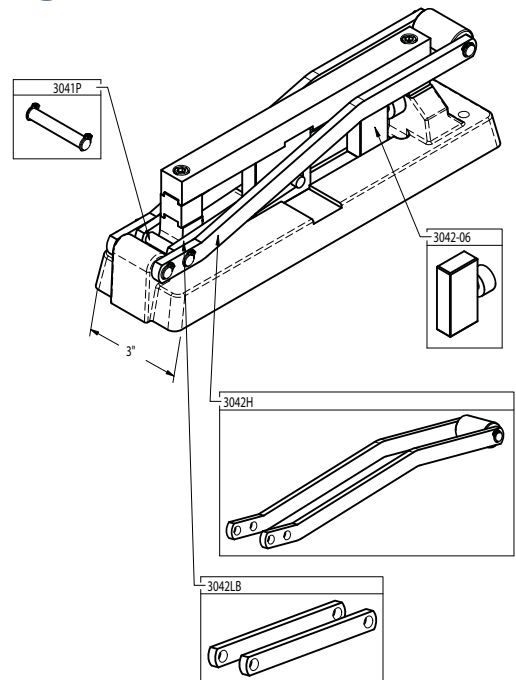
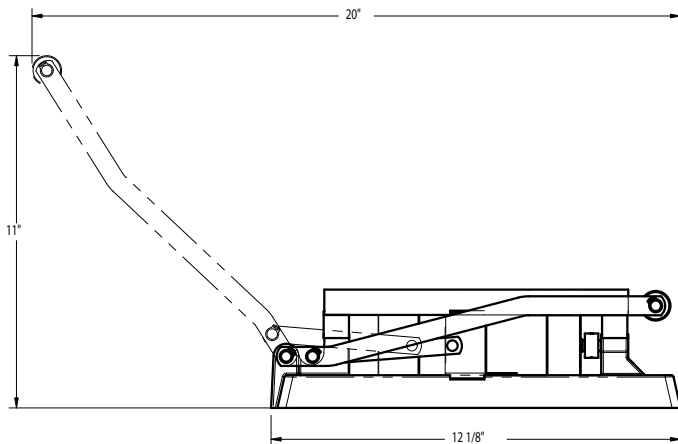

Part #	Description
3041P	die pin
3042-06	27/32" die end block w/screw
3042H	handle
3042LB	lever bracket

Dixon Valve & Coupling Co.
 800 High Street
 Chestertown, MD 21620



877.963.4966
 Fax: 800.283.4966
www.dixonvalve.com