



F100

# Jack-type tool

For applying 3/8" and 5/8" width band clamps



## Operating Instructions for the F100 Installation Tool

**1**

Hold tool as shown with ball handle all the way forward. Insert clamp and push the end entirely into the tool until the lock is held in pusher housing jaws.

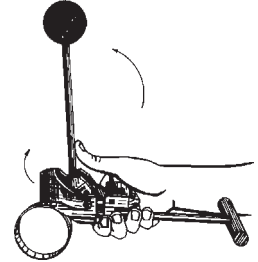
**2**

Slip the hose with nipple inserted into the clamp and locate clamp directly over groove - (position of groove can be laid out on hose with chalk), tighten the clamp with downward strokes of ball handle, using short strokes after initial slack is out so that ball handle finishes in down position.

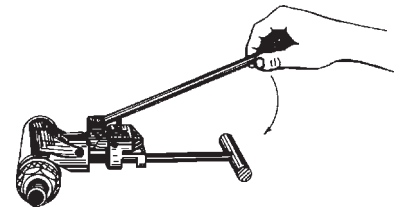
**3**

Hold the tool with clamp resting on Vee block, vise or other solid surface. Swing punch head down against lock and strike hard with mallet; this locks the clamp. Raise punch head to free punch. Hold hose to keep from turning and raise both handles of tool up together which will break off band at lock. **(optional)** Peen corners of the lock down smooth. To remove cut off end from tool, operate ball handle to work it through holding dog. Then press release lever and pull strip out toward rear of tool.

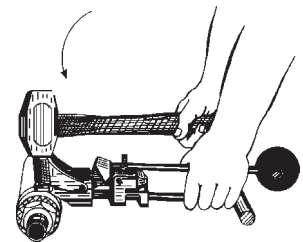

*Instructions for using adapter to apply 3/8" width clamps*

**4**

The F100 tool described above, as shipped, is ready for use in applying all sizes of 5/8" standard and heavy duty hose clamps. To apply the 3/8" wide clamps use the adapter (F-229).

To insert the adapter, hold the tool with the punch head (FX-201) raised as shown and place the adapter under the pusher nose with the bent ends up and push back until the shoulder rests against the front of the pusher nose. The F-229 clamp adapter under the pusher nose (F-206) centers the narrower clamp in the tool.

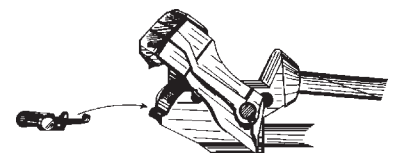

## Part Identification for the F100 Installation Tool

For applying 3/8" and 5/8" band clamps

Illustrations are not in correct proportion to one another.

| Qty Per Tool | Part Description       | Part #  |
|--------------|------------------------|---------|
| 1            | Punch head             | FX-201  |
| 1            | Punch                  | F-202   |
| 1            | Punch head pin         | F-233   |
| 1            | Pusher nose            | F-206   |
| 1            | Holding dog            | F-207   |
| 1            | Pusher nose pin        | F-208   |
| 1            | Holding dog spring     | F-209   |
| 2            | Puller links           | FX-211A |
| 2            | Puller links           | FX-211B |
| 1            | Puller link pin        | F-212   |
| 1            | Pulling dog            | FY-214  |
| 1            | Pulling dog spring     | FY-217  |
| 1            | Pulling dog pin        | F-233   |
| 1            | Ball handle assembly   | FA-220  |
| 1            | 3/8" clamp adapter     | F-229HT |
| 1            | Pusher puller assembly | FA-231  |
| 3            | Retaining rings        | F-242   |
| 1            | Crescent ring          | F-232   |
| 1            | Punch retainer ring    | F-235   |

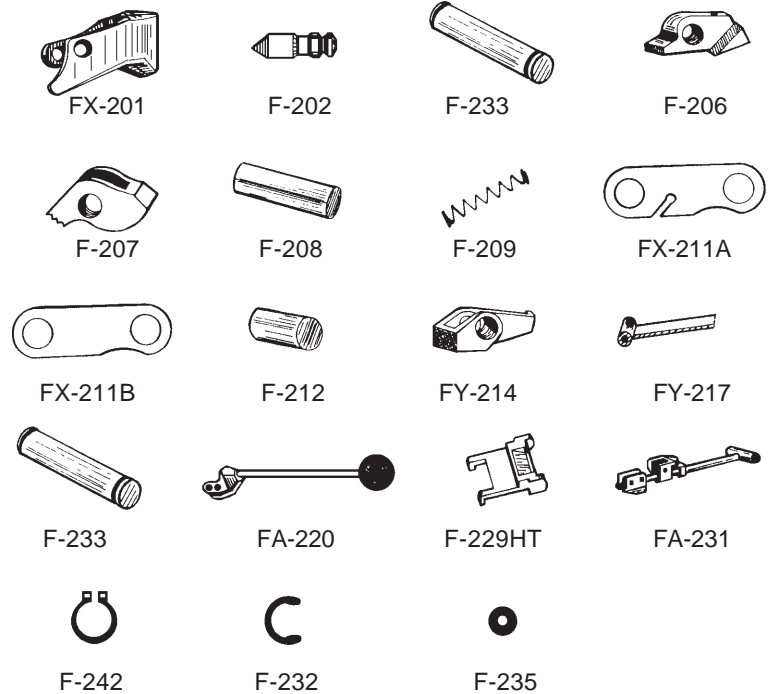

### Sliding Jack Replacement Kit FY205K

(Kit fits the F100 and C2 Tools)



### Dixon Valve & Coupling Co.

800 High Street  
Chestertown, MD 21620  
877.963.4966  
Fax: 800.283.4966  
[www.dixonvalve.com](http://www.dixonvalve.com)