

Clamp Fittings - Adapters

Rubber Hose - 14MPHR

Tube OD	Hose Size	Dimensions		304 Stainless Steel Part #	316L Stainless Steel Part #
		A	B		
1/2"	1/4"	1.500"	.290"	---	14MPHR-R5025
	1/2"	1.500"	.540"	---	14MPHR-R50
	3/4"	1.500"	.790"	---	14MPHR-R5075
3/4"	1/4"	1.500"	.290"	---	14MPHR-R7525
	3/8"	1.500"	.415"	---	14MPHR-R75375
	1/2"	1.500"	.540"	---	14MPHR-R7550
1"	3/4"	1.500"	.790"	---	14MPHR-R75
	1"	1.688"	1.040"	14MPHR-G10075 14MPHR-G100	14MPHR-R100375 14MPHR-R10050 14MPHR-R10075 14MPHR-R100
	1 1/2"	1.687"	1.540"	14MPHR-G15050 14MPHR-G15075 14MPHR-G150100 14MPHR-G150	14MPHR-R15050 14MPHR-R150625 14MPHR-R15075 14MPHR-R150100 14MPHR-R150
1 1/2"	1/2"	1.500"	.540"	---	14MPHR-R200150
	5/8"	1.500"	.665"	---	14MPHR-R200
	3/4"	1.500"	.790"	14MPHR-G200150 14MPHR-G200	14MPHR-R15050 14MPHR-R150625 14MPHR-R15075 14MPHR-R150100 14MPHR-R150
2"	1 1/2"	2.312"	1.540"	14MPHR-G250	14MPHR-R250
	2"	2.312"	2.040"	14MPHR-G300	14MPHR-R300
2 1/2"	2 1/2"	2.344"	2.540"	14MPHR-G400	14MPHR-R400
3"	3"	3.094"	3.040"	14MPHR-G600	14MPHR-R600
4"	4"	3.406"	4.040"		
6"	6"	3.406"	6.040"		

Sanitary Fittings

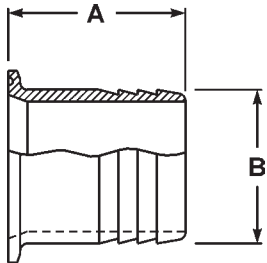

Brewery Hose Barb - 14MPHRL

Feature:

- suitable for use with band clamps

Tube OD	Dimensions		304 Stainless Steel Part #
	A	B	
1"	3.500"	1.045"	14MPHRL100
1 1/2"	5.000"	1.545"	14MPHRL150
2"	5.000"	2.045"	14MPHRL200
2 1/2"	5.500"	2.545"	14MPHRL250
3"	5.500"	3.045"	14MPHRL300
4"	5.500"	4.045"	14MPHRL400

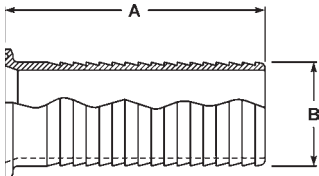

Use of PVC tubing requires special installation techniques to prevent leakage. All assembly work must be done with heated tube. Cold durometer is 90 as opposed to rubber hose at 65 to 70 durometer. Banding buckles must be at 180° from one another. 