

British Instantaneous Fittings

Hose Shanks

Size	Brass Part #
2½" male BRIT x 1½" hose shank	BIE150
2½" male BRIT x 2½" hose shank	BIE250
2½" female BRIT x 1½" hose shank	BIC150
2½" female BRIT x 2½" hose shank	BIC250



BIE150

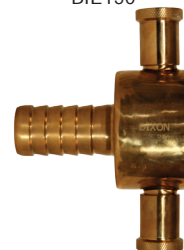

BIC150

Fire Fittings & Accessories

Plug

Size	Brass Part #
2½"	BIDP250



Cap

Size	Brass Part #
2½"	BIDC250



International Shore Connections

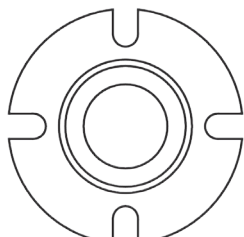

ship connection
09-319

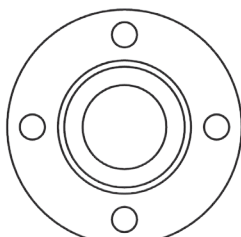

shore connection
09-318

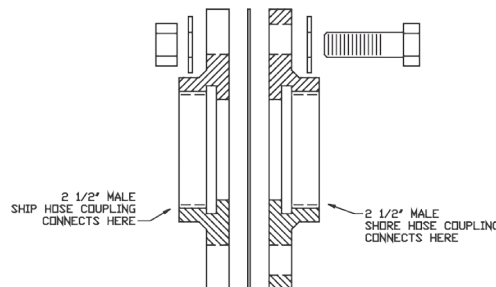

Features:

- meets US Coast Guard specifications for vessels 1000 gross tons or more
- makes possible the connection of two different threads between ship and shore or between ships
- 7" OD brass flange with 4¾" holes
- includes 8 washers, 4 hexagon brass nuts, 4 hex head bolts, 1 washer, 1 fiber gasket
- working pressure: **300 PSI**
- NST (NH) threads standard, also available in NPT and NYFD threads

Description	Brass Part #
shore side	09-318-00001
ship side	09-319-00001



shore side



ship side